



# COLLECTOR SWEEPER

# MANTA HD

## TECHNICAL SPECIFICATIONS

- 1 Transmission with chain and sprockets
- 2 Internal rotor set up with polypropylene brushes
- 3 Internal rotor set up with mixed polypropylene / steel brushes

## DESCRIPTION

MANTA HD is a collector sweeper for frontal applications on big tracked or wheeled skid-steer loaders, loaders, backhoe loaders and telehandlers. Each MANTA HD model is equipped as standard with side and front protection rubber bands, flexible hoses, **HARDOX® slides** and **double cut knife in wear resistant steel** bolted under the collector bucket.

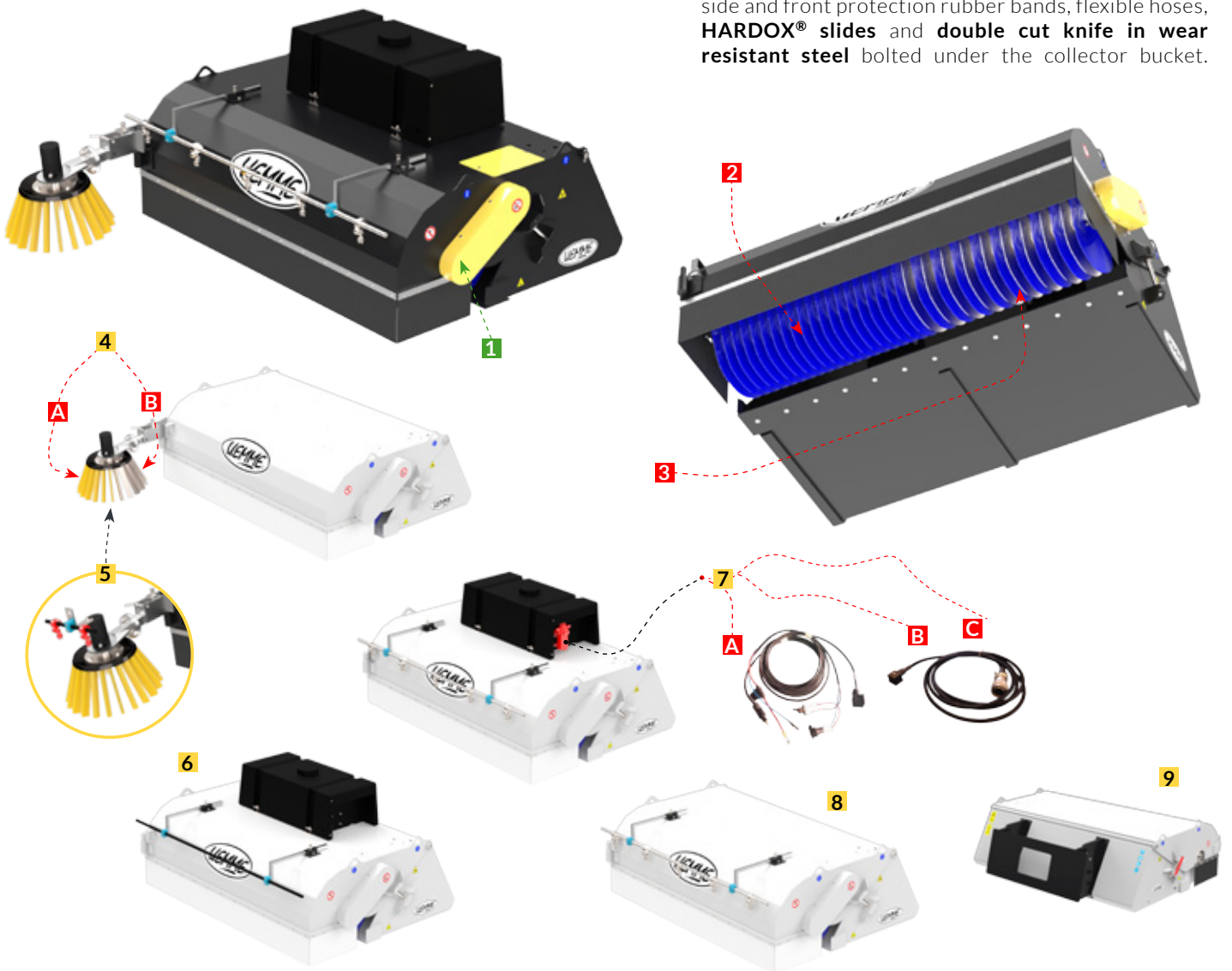

MODELS		MANTA 1800 HD	MANTA 2100 HD	MANTA 2500 HD
Working width	mm	1800	2100	2500
Total width	mm	1920	2220	2600
Weight without linkage	Kg	450	485	610
Bucket capacity	lt	510	596	706
Brushes	Ø / nr	560 / 38	560 / 45	560 / 52
Maximum oil flow	l/1'	90	90	100
Maximum pressure	bar	215	215	245
	Tons	3÷6,5	3,5÷8	5÷14

**OPTIONS**

- 4** Adjustable arm for side cleaning brush with independent hydraulic motor
  - A** Ø 580 mm. polypropylene brush
  - B** Ø 580 mm. steel brush
- 5** Watering kit for side cleaning brush
- 6** Falling watering kit complete by 100 lts tank
- 7** Pressure watering kit complete by 100 lts tank electric pump and water spray nozzles
  - A** Standard electrical kit
  - B** 8 pins connector
  - C** 14 pins connector
- 8** Pressure watering kit with tank already present on the host machine
- 9** Floating connetcion plate

**LINKAGE SYSTEMS**

- Universal linkage for Skid-Steer Loader
- Non universal linkage for Skid-Steer Loader
- Wheel L., Backhoe L. & Telehandlers linkage

**APPLICATIONS**

- INDUSTRIAL SECTOR
- BUILDING SECTOR
- ROADS, CYCLE PATHS, HISTORICAL CENTERS, PARKING LOTS CLEANING
- PORT AREAS, COMPANY COURTYARDS, CONSTRUCTION SITES CLEANING
- MILLED ASPHALT COLLECTION
- GRAVEL AND DEBRIS COLLECTION
- DUST AND SOIL REMOVAL FROM ROAD SURFACES

