



INTERCHANGEABLE BROOM

LINCE



TECHNICAL SPECIFICATIONS

- 1 Internal rotor set up with polypropylene brushes
- 2 Internal rotor set up with mixed PPN / steel brushes
- 3 Mechanical angulation set up
- 4 Hydraulic angulation set up

DESCRIPTION

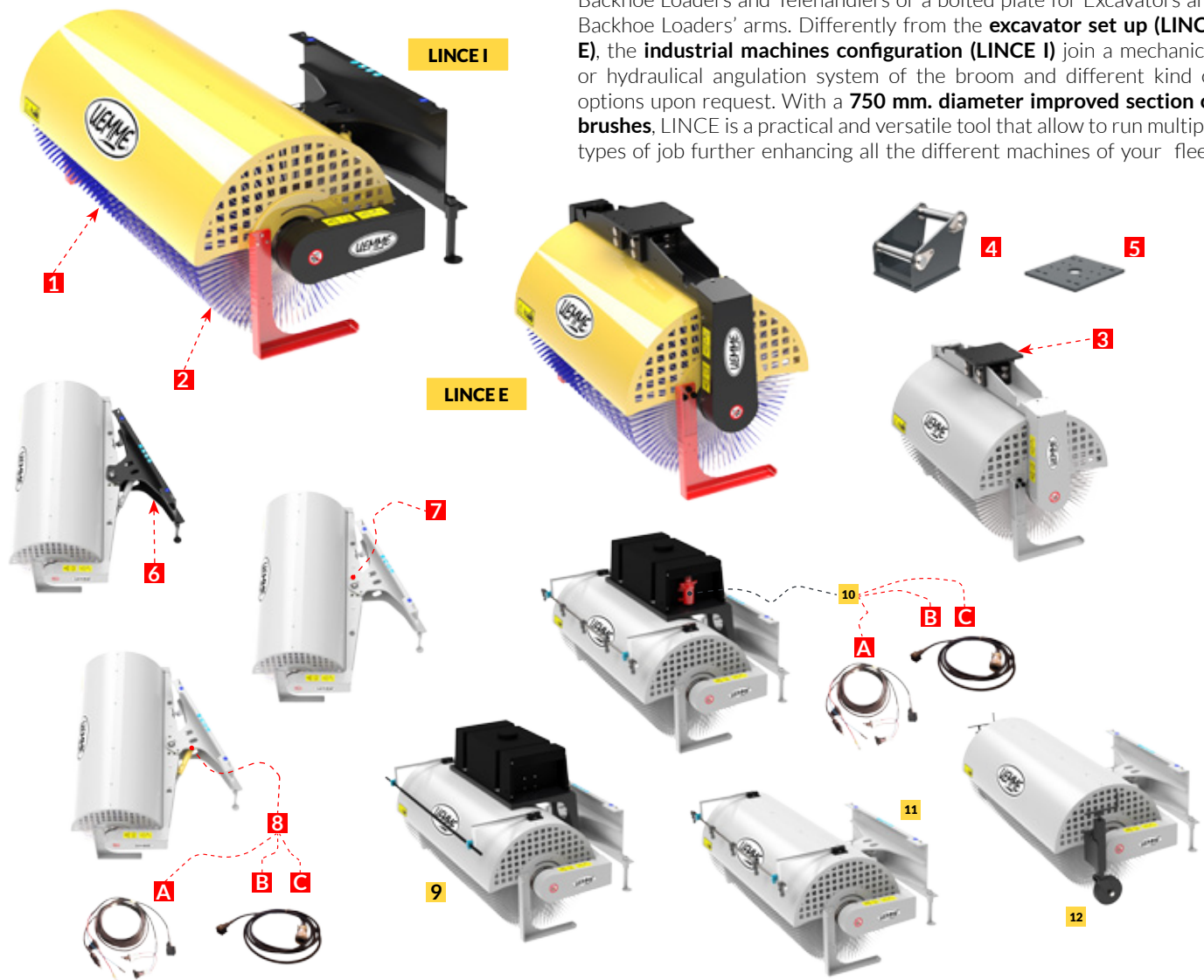
LINCE is a rotating brooms with **interchangeable linkage system**. Each model in fact needs to be combined with a specific connection system allowing the linkage between the broom and the machinery you decide to use: a frontal kind of linkage for SSL, small Loaders, Backhoe Loaders and Telehandlers or a bolted plate for Excavators and Backhoe Loaders' arms. Differently from the **excavator set up (LINCE E)**, the **industrial machines configuration (LINCE I)** join a mechanical or hydraulic angulation system of the broom and different kind of options upon request. With a **750 mm. diameter improved section of brushes**, LINCE is a practical and versatile tool that allow to run multiple types of job further enhancing all the different machines of your fleet.



MODELS		LINCE 1250	LINCE 1550	LINCE 1800	LINCE 2100
Working width	mm	1250	1550	1800	2100
Total width	mm	1430	1730	1980	2280
Maximum angulation (LINCE I only)	°	± 30	± 30	± 30	± 30
Working width at maximum angulation	mm	1010	1310	1525	1810
Total width at maximum angulation	mm	1480	1780	2000	2260
Weight without linkage	Kg	215	235	255	272
Brushes	Ø / nr	750 / 25	750 / 34	750 / 38	750 / 45
Maximum oil flow	l/1'	90	90	90	90
Maximum pressure	bar	215	215	215	215
	Tons	0,4÷1,8	0,7÷3	1,5÷4,5	2,5÷7
	Tons	1÷2	1,5÷3,5	2÷4,5	3,5÷6,5

LINKAGE SYSTEMS

- 3** Bolted plate for excavators or backhoe loaders
- 4** Standard bolted seat
- 5** Bolted naked plate for quick coupler
- 6** Linkage plate with central joint for ± 30° angulation system
 - 1** Universal linkage for Skid-Steer Loader
 - 2** Non universal linkage for Skid-Steer Loader
 - 3** W. Loaders, Backhoe L. & Telehandlers linkage

ANGULATION

- 7** Mechanical angulation kit
- 8** Hydraulic angulation kit composed by hydraulic cylinders + electrovalve
 - A** Standard electrical kit
 - B** 8 pins connector
 - C** 14 pins connector

OPTIONS (only for frontal linkage set up)

- 9** Falling watering kit complete by 100 lts tank
- 10** Pressure watering kit complete by 100 lts tank, electric pump and rod with water spray nozzles
 - A** Standard electrical kit
 - B** 8 pins connector
 - C** 14 pins connector
- 11** Pressure watering kit with tank already present on the host machine
- 12** Pair of side free 360° rotating wheels adjustable in height

APPLICATIONS

- INDUSTRIAL SECTOR
- BUILDING SECTOR
- AGRICULTURAL SECTOR
- ZOOTECHNY
- CONSTRUCTION SITES, COURTYARDS AND SQUARES FAST CLEANING
- LOW LAYERS OF SNOW REMOVAL
- REMOVAL OF MOSS FROM SELF-LOCKING FLOORS
- VERTICAL AND INCLINED WALLS CLEANING
- IRRIGATION CHANNELS CONCRETE BANKS CLEANING
- CANOPIES AND TUNNELS CLEANING
- GUARD RAIL AND BARRIERS CLEANING



3 4



6 7



10